

DUO-FAST[®]

NAIPLERS STAPLERS FASTENERS[™]
SUPER SureShot[™]
CS-5000

1011916
DUO-FAST CORPORATION
AN ITW COMPANY
2400 GALVIN DRIVE
ELGIN, ILLINOIS 60123-7883
U.S.A.

CS-186-5000

08/02

200 DUO-FAST Corporation

*Part of CT-310-P3

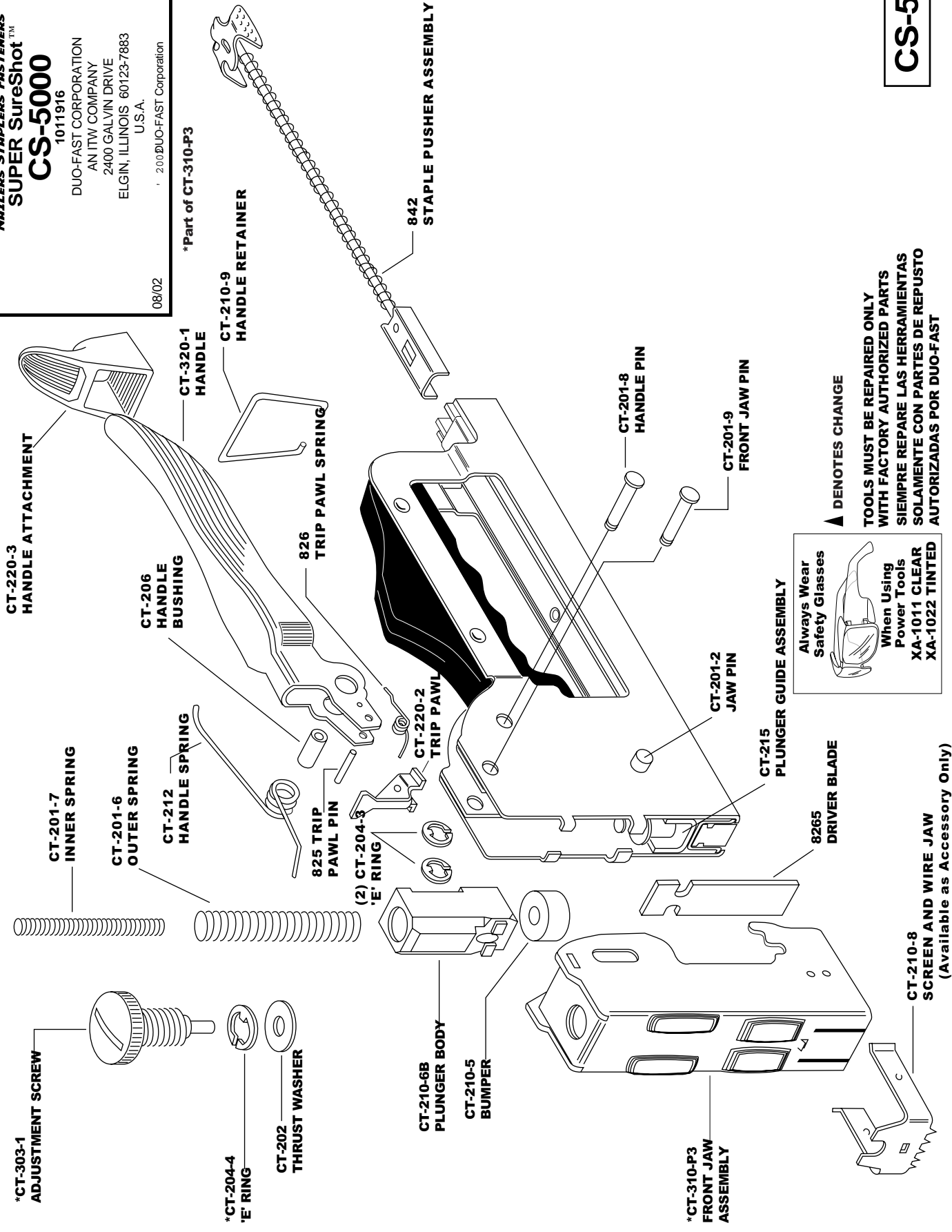

*CT-303-1
ADJUSTMENT SCREW

CT-201-7
INNER SPRING

CT-201-6
OUTER SPRING

CT-212
HANDLE SPRING

CT-206
HANDLE BUSHING

CT-320-1
HANDLE

CT-210-9
HANDLE RETAINER

CT-202
THRUST WASHER

*CT-204-4
'E' RING

825 TRIP PAWL PIN

(2) CT-204-3
'E' RING

CT-210-6B
PLUNGER BODY

CT-210-5
BUMPER

CT-220-2
TRIP PAWL

842
STAPLE PUSHER ASSEMBLY

*CT-310-P3
FRONT JAW ASSEMBLY

CT-215
PLUNGER GUIDE ASSEMBLY

8265
DRIVER BLADE

CT-201-2
JAW PIN

CT-201-8
HANDLE PIN

CT-201-9
FRONT JAW PIN

CT-210-8
SCREEN AND WIRE JAW
(Available as Accessory Only)

▲ DENOTES CHANGE

TOOLS MUST BE REPAIRED ONLY
WITH FACTORY AUTHORIZED PARTS
SIEMPRE REPARA LAS HERRAMIENTAS
SOLAMENTE CON PARTES DE REPUESTO
AUTORIZADAS POR DUO-FAST

Always Wear Safety Glasses
When Using Power Tools
XA-1011 CLEAR
XA-1022 TINTED

CS-5000

| <u>UNIQUE #</u> | <u>PART NO.</u> | <u>DESCRIPTION</u> | <u>REPLACES</u> |
|-----------------|-----------------|------------------------|-----------------|
| 0381632 | 825 | TRIP PAWL PIN | _____ |
| 0381640 | 826 | TRIP PAWL SPRING | _____ |
| 0381905 | 842 | STAPLE PUSHER ASSEMBLY | _____ |
| 0386664 | 8265 | DRIVER BLADE | _____ |
| 0437814 | CT-201-2 | JAW PIN | _____ |
| 0437855 | CT-201-6 | OUTER SPRING | _____ |
| 0437863 | CT-201-7 | INNER SPRING | _____ |
| 0441790 | CT-201-8 | HANDLE PIN | _____ |
| 0178111 | CT-201-9 | FRONT JAW PIN | _____ |
| 0437871 | CT-202 | THRUST WASHER | _____ |
| 0437822 | CT-204-3 | E-RING | _____ |
| 0437830 | CT-204-4 | E-RING | _____ |
| 0437897 | CT-206 | HANDLE BUSHING | _____ |
| 0442434 | CT-210-5 | BUMPER | _____ |
| 0236588 | CT-210-6B | PLUNGER BODY | _____ |
| 0178129 | CT-210-9 | HANDLE RETAINER | _____ |
| 0437947 | CT-212 | HANDLE SPRING | _____ |
| 0438275 | CT-215 | PLUNGER GUIDE ASSEMBLY | _____ |
| 0437962 | CT-220-2 | TRIP PAWL | _____ |
| 0455733 | CT-220-3 | HANDLE ATTACHMENT | _____ |
| 1011912 | CT-303-1 | ADJUSTMENT SCREW | _____ |
| 1011913 | CT-320-1 | HANDLE | _____ |
| 1011917 | XH-108-80 | MODEL LABEL | _____ |

ACCESSORIES

| | | | |
|---------|-------------|----------------------|-----------------|
| 0440925 | CT-210-8 | SCREEN AND WIRE JAW | _____ |
| 1014271 | * CT-310-P3 | * FRONT JAW ASSEMBLY | <u>CT-310-4</u> |

* = NEW PART

> = PART CHANGE

CS-5000
08/02 (6) GC